

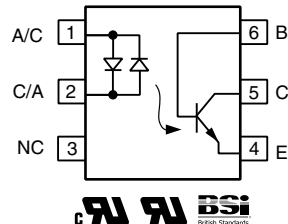

Optocoupler, Phototransistor Output, AC Input, With Base Connection

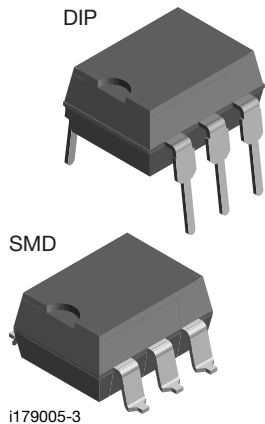

FEATURES

- AC or polarity insensitive inputs
- Continuous forward current, 130 mA
- Built-in reverse polarity input protection
- Improved CTR symmetry
- Industry standard DIP package
- Material categorization: for definitions of compliance please see www.vishay.com/doc?99912



RoHS
COMPLIANT

APPLICATIONS

- Telecommunications
- Ring detection
- Loop current detector

AGENCY APPROVALS

- UL1577, file no. E52744, double protection
- cUL tested to CSA 22.2 bulletin 5A
- BSI EN 60950, BSI EN 60065

DESCRIPTION

The IL255 is a bidirectional input optically coupled isolator consisting of two high current GaAs infrared LEDs coupled to a silicon NPN phototransistor. The IL255 has a minimum CTR of 20 %.

This optocoupler is ideal for applications requiring AC signal detection and monitoring.

ORDERING INFORMATION

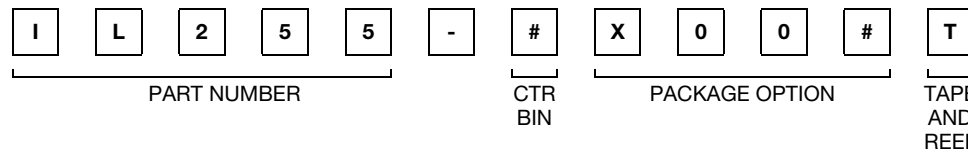

AGENCY CERTIFIED/PACKAGE	CTR (%)	
UL, cUL, BSI	≥ 20	≥ 50
DIP-6	-	IL255-2
SMD-6, option 7	IL255-X007T	-

ABSOLUTE MAXIMUM RATINGS (T_{amb} = 25 °C, unless otherwise specified)

PARAMETER	TEST CONDITION	SYMBOL	VALUE	UNIT
INPUT				
Peak pulsed current	1 μs, 300 pps	I _{FP}	3	A
Forward continuous current		I _F	130	mA
Power dissipation		P _{diss}	175	mW
Derate linearly from 25 °C			2.3	mW/°C
OUTPUT				
Collector emitter breakdown voltage		BV _{CEO}	30	V
Emitter base breakdown voltage		BV _{EBO}	5	V
Collector base breakdown voltage		BV _{CBO}	70	V
Power dissipation		P _{diss}	200	mW
Derate linearly from 25 °C			2.6	mW/°C



ABSOLUTE MAXIMUM RATINGS ($T_{amb} = 25\text{ }^{\circ}\text{C}$, unless otherwise specified)				
PARAMETER	TEST CONDITION	SYMBOL	VALUE	UNIT
COUPLER				
Total dissipation		P_{tot}	250	mW
Derate linearly from 25 °C			3.3	mW/°C
Storage temperature		T_{stg}	-55 to +150	°C
Operating temperature		T_{amb}	-55 to +100	°C
Lead soldering time at $\geq 260\text{ }^{\circ}\text{C}$ (1)			10	s

Notes

- Stresses in excess of the absolute maximum ratings can cause permanent damage to the device. Functional operation of the device is not implied at these or any other conditions in excess of those given in the operational sections of this document. Exposure to absolute maximum ratings for extended periods of the time can adversely affect reliability
- (1) Refer to reflow profile for soldering conditions for surface mounted devices (SMD). Refer to wave profile for soldering conditions for through hole devices (DIP)

ELECTRICAL CHARACTERISTICS ($T_{amb} = 25\text{ }^{\circ}\text{C}$, unless otherwise specified)							
PARAMETER	TEST CONDITION	PART	SYMBOL	MIN.	TYP.	MAX.	UNIT
INPUT							
Forward voltage	$I_F = \pm 100\text{ mA}$		V_F		1.4	1.7	V
OUTPUT							
Collector emitter breakdown voltage	$I_C = 10\text{ mA}$		BV_{CEO}	30	50	-	V
Emitter collector breakdown voltage	$I_E = 10\text{ }\mu\text{A}$		BV_{ECO}	7	10	-	V
Collector base breakdown voltage	$I_C = 100\text{ }\mu\text{A}$		BV_{CBO}	70	-	-	V
Emitter base breakdown voltage	$I_E = 100\text{ }\mu\text{A}$		BV_{EBO}	70	-	-	V
Collector emitter leakage current	$V_{CE} = 10\text{ V}$		I_{CEO}	-	5	50	nA
COUPLER							
Collector emitter saturation voltage	$I_F = \pm 10\text{ mA}, I_C = 0.5\text{ mA}$	IL255	V_{CEsat}	-	-	0.4	V
	$I_F = \pm 16\text{ mA}, I_C = 2\text{ mA}$	IL255-2	V_{CEsat}	-	-	0.4	V

Note

- Minimum and maximum values are testing requirements. Typical values are characteristics of the device and are the result of engineering evaluation. Typical values are for information only and are not part of the testing requirements

CURRENT TRANSFER RATIO ($T_{amb} = 25\text{ }^{\circ}\text{C}$, unless otherwise specified)							
PARAMETER	TEST CONDITION	PART	SYMBOL	MIN.	TYP.	MAX.	UNIT
Current transfer ratio	$I_F = \pm 10\text{ mA}, V_{CE} = 10\text{ V}$	IL255	CTR	20	-	-	%
	$I_F = \pm 10\text{ mA}, V_{CE} = 10\text{ V}$	IL255-2	CTR	50	-	-	%
Current transfer ratio symmetry	$I_F = \pm 10\text{ mA}, V_{CE} = 10\text{ V}$	IL255		0.33	-	3	
	$I_F = \pm 10\text{ mA}, V_{CE} = 10\text{ V}$	IL255-2		0.5	1	2	



SAFETY AND INSULATION RATINGS				
PARAMETER	TEST CONDITION	SYMBOL	VALUE	UNIT
Climatic classification	According to IEC 68 part 1		55 / 100 / 21	
Comparative tracking index		CTI	175	
Maximum rated withstanding isolation voltage	t = 1 min	V_{ISO}	4420	V_{RMS}
Maximum transient isolation voltage		V_{IOTM}	10 000	V_{peak}
Maximum repetitive peak isolation voltage		V_{IORM}	890	V_{peak}
Isolation resistance	$V_{IO} = 500 V, T_{amb} = 25\text{ }^{\circ}C$	R_{IO}	$\geq 10^{12}$	Ω
	$V_{IO} = 500 V, T_{amb} = 100\text{ }^{\circ}C$	R_{IO}	$\geq 10^{11}$	Ω
Output safety power		P_{SO}	400	mW
Input safety current		I_{SI}	275	mA
Safety temperature		T_S	175	$^{\circ}C$
Creepage distance			≥ 7	mm
Clearance distance			≥ 7	mm
Insulation thickness		DTI	≥ 0.4	mm

Note

- As per IEC 60747-5-5, § 7.4.3.8.2, this optocoupler is suitable for “safe electrical insulation” only within the safety ratings. Compliance with the safety ratings shall be ensured by means of protective circuits

TYPICAL CHARACTERISTICS ($T_{amb} = 25\text{ }^{\circ}C$, unless otherwise specified)

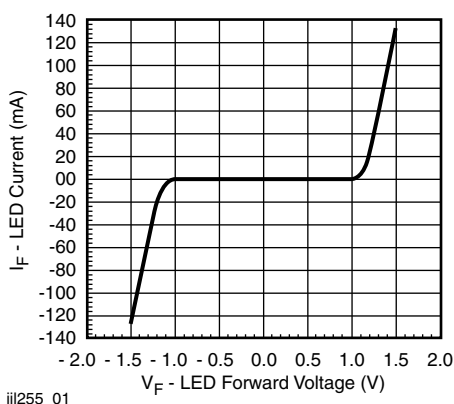

iii255_01

Fig. 1 - LED Forward Current vs. Forward Voltage

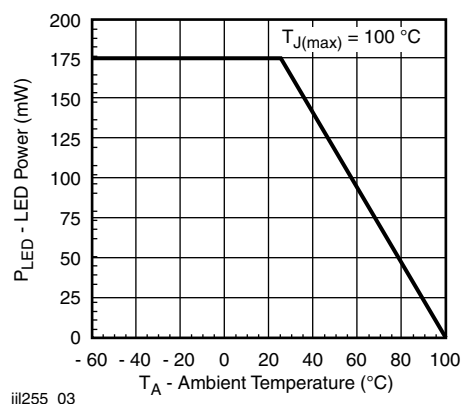

iii255_03

Fig. 3 - Maximum LED Power Dissipation

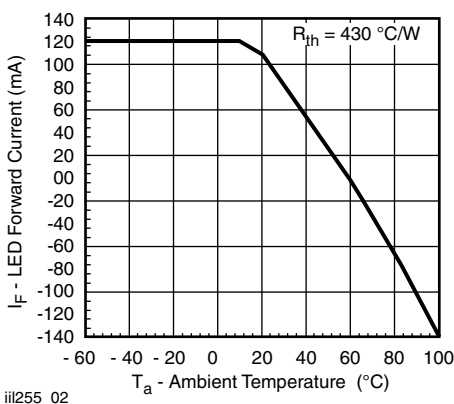

iii255_02

Fig. 2 - Maximum LED Current vs. Ambient Temperature

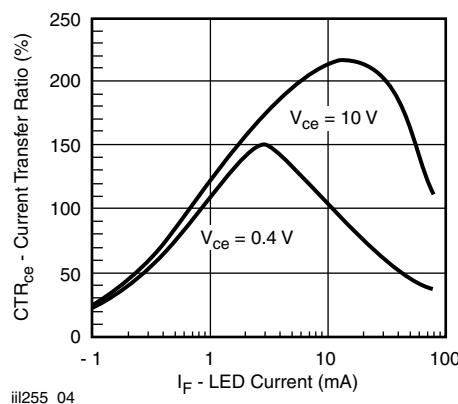

iii255_04

Fig. 4 - Current Transfer Ratio vs. LED Current and Collector-Emitter Voltage

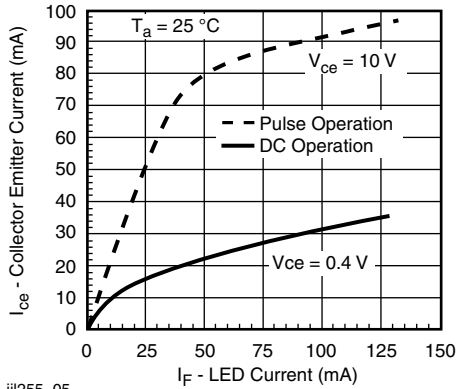

iii255_05

Fig. 5 - Non-Saturated and Saturated Collector Emitter Current vs. LED Current

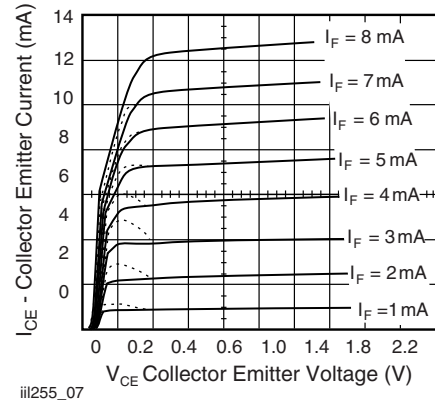

iii255_07

Fig. 7 - Collector Emitter Current vs. LED Collector Emitter Voltage

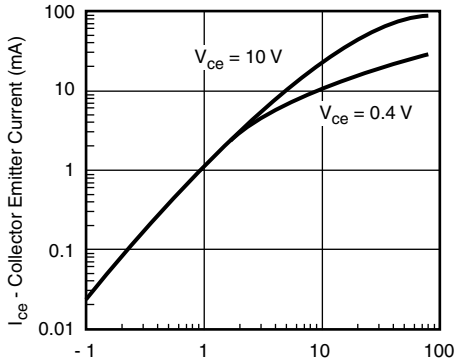

iii255_06

Fig. 6 - Non-Saturated and Saturated Collector Emitter Current vs. LED Current

PACKAGE DIMENSIONS in millimeters

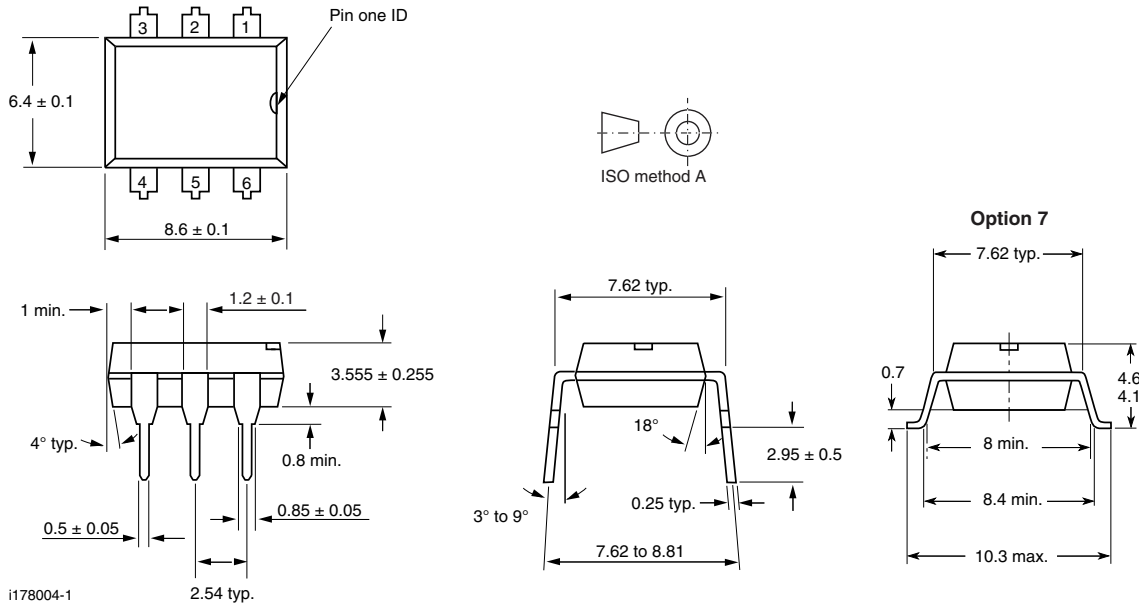

i178004-1



PACKAGE MARKING



Notes

- Only option 7 reflected in the package marking
- Tape and reel suffix (T) is not part of the package marking



Disclaimer

ALL PRODUCT, PRODUCT SPECIFICATIONS AND DATA ARE SUBJECT TO CHANGE WITHOUT NOTICE TO IMPROVE RELIABILITY, FUNCTION OR DESIGN OR OTHERWISE.

Vishay Intertechnology, Inc., its affiliates, agents, and employees, and all persons acting on its or their behalf (collectively, "Vishay"), disclaim any and all liability for any errors, inaccuracies or incompleteness contained in any datasheet or in any other disclosure relating to any product.

Vishay makes no warranty, representation or guarantee regarding the suitability of the products for any particular purpose or the continuing production of any product. To the maximum extent permitted by applicable law, Vishay disclaims (i) any and all liability arising out of the application or use of any product, (ii) any and all liability, including without limitation special, consequential or incidental damages, and (iii) any and all implied warranties, including warranties of fitness for particular purpose, non-infringement and merchantability.

Statements regarding the suitability of products for certain types of applications are based on Vishay's knowledge of typical requirements that are often placed on Vishay products in generic applications. Such statements are not binding statements about the suitability of products for a particular application. It is the customer's responsibility to validate that a particular product with the properties described in the product specification is suitable for use in a particular application. Parameters provided in datasheets and / or specifications may vary in different applications and performance may vary over time. All operating parameters, including typical parameters, must be validated for each customer application by the customer's technical experts. Product specifications do not expand or otherwise modify Vishay's terms and conditions of purchase, including but not limited to the warranty expressed therein.

Except as expressly indicated in writing, Vishay products are not designed for use in medical, life-saving, or life-sustaining applications or for any other application in which the failure of the Vishay product could result in personal injury or death. Customers using or selling Vishay products not expressly indicated for use in such applications do so at their own risk. Please contact authorized Vishay personnel to obtain written terms and conditions regarding products designed for such applications.

No license, express or implied, by estoppel or otherwise, to any intellectual property rights is granted by this document or by any conduct of Vishay. Product names and markings noted herein may be trademarks of their respective owners.